

NOTE: THIS DRAWING IS THE PROPERTY OF  
 CHANGING MARINE  
 SEATTLE, WASH., U.S.A. AND MUST BE RETURNED.  
 IT SHALL NOT BE USED FOR CONSTRUCTION OR  
 MANUFACTURE, OR DUPLICATED OR COPIED OR  
 SUBMITTED TO OUTSIDE PARTIES WITHOUT OUR  
 WRITTEN CONSENT.

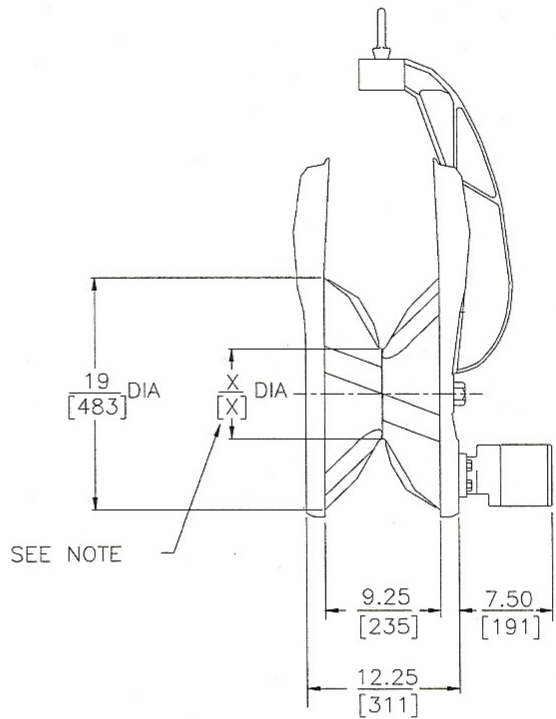
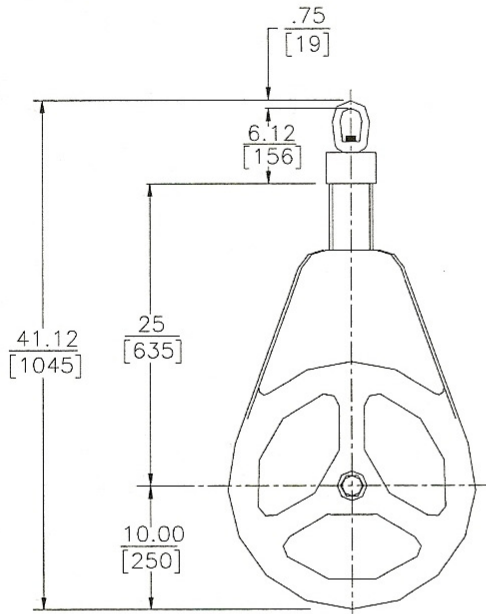

SPECIFICATIONS

	<u>DRIVE OPTION A</u>	<u>DRIVE OPTION B</u>
HYDRAULIC OIL INPUT:	15 GPM AT 1500 PSI 56 l/min AT 10344 KPA	6 GPM AT 1500 PSI 22 l/min AT 10344 KPA
NET PULL AT 1/2 RADIUS:	2300 LB 1075 KG	950 LB 430 KG
SHEAVE SPEED:	51 RPM	62 RPM

CONSTRUCTION:

SIDE SHELLS: CAST ALUMINUM  
 SHEAVE: CAST ALUMINUM

WEIGHTS:

B19E POWER BLOCK: 148LB/67KG

NOTES:

RUBBER SHEAVE THROAT DIA =  $\frac{8}{[203]}$  DIA  
 ALUMINUM SHEAVE THROAT DIA =  $\frac{6.5}{[165]}$  DIA

DIMENSIONS ARE IN  $\frac{\text{INCHES}}{[MILLIMETERS]}$

SUBJ B19E PURETIC POWER BLOCK			
TITLE OUTLINE AND SPECIFICATION DRAWING			
DRN	WLB	APPD	SCALE
CHK	DATE	7/15/97	1:16
DWG. NO. 64470		REV A	

PATENT GRANTED AND PENDING IN  
 THE U.S.A. AND FOREIGN COUNTRIES

